

DIN 7 And ISO 2338

Dowel Pins Are Made To Several National And International Standards Each With Slight Differences
In Chamfer Forms Toleranced And Available Materials

Examples Below Show The Difference Between

DIN 7 Where The Overall Length DOES NOT Include Dimension C
Please refer To The DIN 7 Specification Sheet For The C Dimensions

And The ISO 2338 Where The L Dimension DOES Include The C Dimension
And Is Therefore Measured Over The Whole Length (L) Of The Pin

DIN 7

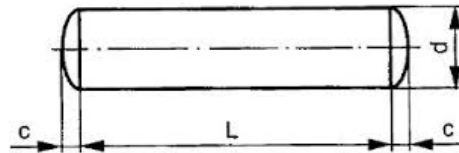

ISO 2338

